

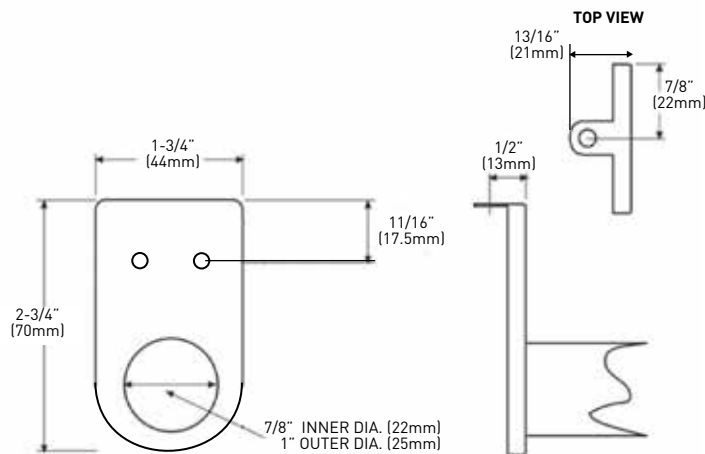

SPECIFICATIONS

- › STEEL CONSTRUCTION
- › 1" (25 mm) DIAMETER ROD
- › INCLUDES COMBO HEAD SCREWS



MEASUREMENTS SUBJECT TO A 3% VARIANCE

MEASUREMENTS ARE FOR REFERENCE ONLY. TAYMOR RESERVES THE RIGHT TO CHANGE THE PRODUCT SPECS WITHOUT NOTICE. FOR PRODUCT WARRANTY, PLEASE VISIT TAYMOR WEBSITE FOR DETAILS

Adjustable Steel Closet Rod

POLY BAGGED WITH UPC	STEEL	WHITE ENAMEL	MAX. WEIGHT CAPACITY	CASE QTY.
18" - 30" (457 mm - 762 mm)	25-MR1830	25-MR1830W	100 LBS	10
30" - 48" (762 mm - 1219 mm)	25-MR3048	25-MR3048W	100 LBS	10
48" - 72" (1219 mm - 1829 mm)	25-MR4872	25-MR4872W	100 LBS	10
72" - 96" (1829 mm - 2438 mm)	25-MR7296	25-MR7296W	100 LBS	10
96" - 120" (2438 mm - 3048 mm)	25-MR96120	25-MR96120W	150 LBS*	10

* REQUIRES INSTALLATION OF CENTER BRACKET (INCLUDED)

